

South Australia

Liquor Licensing (Dry Areas—Short Term) Regulations 1997

under the *Liquor Licensing Act 1997*

Contents

- 1 Short title
- 3 Interpretation
- 4 Short term dry areas (section 131 of the Act)
- 5 Plans of short term dry areas

Schedule 1—Short term dry areas

Schedule 2—Plans of short term dry areas

Legislative history

1—Short title

These regulations may be cited as the *Liquor Licensing (Dry Areas—Short Term) Regulations 1997*.

3—Interpretation

- (1) In these regulations, unless the contrary intention appears—
 - the Act* means the *Liquor Licensing Act 1997*;
 - container* means the container in which liquor is sealed so that it cannot escape but does not include packaging in which the container is sold;
 - private land* means any land that is not a public place within the meaning of the Act;
 - street or road* includes an avenue, terrace, lane, crescent, court, place or other land set aside for the carriage of vehicular traffic.
- (2) Unless the contrary intention appears, a reference in these regulations to a street or a road is a reference to—
 - (a) the carriageway of the street or road; and
 - (b) the footpaths (if any) of the street or road; and
 - (c) a median strip or traffic island (if any) or any other land separating carriageways of the street or road; and
 - (d) any other land adjoining or adjacent to the carriageway of the street or road being land that has been reserved for the purposes of the street or road.
- (3) For the purposes of these regulations, a wine cask will be taken to have been opened if the tap comprising part of the container is protruding through the external carton.

4—Short term dry areas (section 131 of the Act)

- (1) Subject to subregulation (2), the consumption of liquor or the consumption and possession of liquor are prohibited in accordance with Schedule 1 in the areas described in that Schedule during the periods specified in that Schedule.
- (2) The prohibition does not extend to any private land within an area described in Schedule 1.
- (3) Unless the contrary intention appears, the prohibition in Schedule 1 of the possession of liquor in an area does not extend to—
 - (a) a person who is genuinely passing through the area if—
 - (i) the liquor is in the original container in which it was purchased from licensed premises; and
 - (ii) the container has not been opened; or
 - (b) a person who has possession of the liquor in the course of carrying on a business or in the course of his or her employment by another person in the course of carrying on a business; or
 - (c) a person who is permanently or temporarily residing at premises within the area or on the boundary of the area and who enters the area solely for the purpose of passing through it to enter those premises or who enters the area from those premises for the purpose of leaving the area; or
 - (d) such other persons (if any) who are specifically excluded by Schedule 1.

5—Plans of short term dry areas

- (1) Schedule 2 sets out plans of some of the areas described in Schedule 1.
- (2) If the description of an area in Schedule 1 does not coincide with the plan of the area in Schedule 2, the description will be taken to be correct.

Schedule 1—Short term dry areas

Area	Period	Extent of prohibition
Adelaide—Area 1 (Bonython Park)		
(there is no plan for this area)		
The area in the City of Adelaide known as Bonython Park, being the area bounded by the River Torrens, the eastern boundary of Port Road and the western boundary of the railway reserve running between Port Road and the River Torrens (on the eastern side of the Old Adelaide Gaol) other than any fenced area or areas used for Schutzenfest 2007.	4 p.m. on 12 January 2007 to 1 a.m. on 14 January 2007.	The consumption of liquor is prohibited and the possession of liquor is prohibited.
Alexandrina Council—Area 1 (Chiton Rocks)		
(see Schedule 2: Alexandrina Council—Plan 1)		
The Chiton Rocks Surf Lifesaving Club car park being the whole of allotment 469 and part of allotment 440 in Deposited Plan No. 3482.	6 p.m. on 31 December 2006 to 6 a.m. on 1 January 2007.	The consumption of liquor is prohibited and the possession of liquor is prohibited.
Alexandrina Council—Area 2 (Port Elliot)		
(see Schedule 2: Alexandrina Council—Plan 2)		
Section 294 Hundred of Goolwa including any jetty or other structure extending seaward.	6 p.m. on 31 December 2006 to 6 a.m. on 1 January 2007.	The consumption of liquor is prohibited and the possession of liquor is prohibited.
Alexandrina Council—Area 3 (Middleton)		
(see Schedule 2: Alexandrina Council—Plan 3)		
Commencing at the south-west corner of Section 2303 Hundred of Goolwa then in a north-easterly and northerly direction along the south-eastern and eastern boundaries of Section 2303 to the intersection with the projection of the northern boundary of lot 1 in filed plan 2100, then easterly and south-easterly along that projection and the northern and north-eastern boundary of lot 1 and the northern boundary of lot 101 in deposited plan 10654, then southerly along the eastern boundary of lot 101 to the south-western corner of lot 19 in deposited plan 3145, then generally north-easterly along the northern boundary of Ocean Parade to the western corner of lot 10 in deposited plan 3262, then northerly along the western boundary of Mill Terrace to the north-eastern corner of lot 39 in deposited plan 3262, then in a straight line to the north-western corner of the reserve lot 160 in deposited plan 9417, then in an easterly direction along the southern boundary of the Esplanade to lot 3 in deposited plan 13398, then along the western, northern and eastern boundaries of that lot to its south-eastern	6 p.m. on 31 December 2006 to 6 a.m. on 1 January 2007.	The consumption of liquor is prohibited and the possession of liquor is prohibited.

Liquor Licensing (Dry Areas—Short Term) Regulations 1997—29.11.2007 to 5.12.2007
 Schedule 1—Short term dry areas

Area	Period	Extent of prohibition
<p>corner, then along the northern boundary of Section 345 to its intersection with the projection of the eastern boundary to lot 39 in deposited plan 6156, then southerly along that projection to the high water line, then generally westerly along the high water line to its intersection with the projection of the western boundary of Section 2303 then northerly along the projection to the point of commencement.</p>		
<p>Alexandrina Council—Area 4 (Goolwa Beach Carpark)</p>		
<p>(see Schedule 2: Alexandrina Council—Plan 4)</p>		
<p>Commencing at the north-eastern corner of Section 279, Hundred of Goolwa, then in a westerly and southerly direction along the northern and western boundaries of Section 279, then in a southerly and easterly direction along the western and southern boundaries of Section 367, Hundred of Goolwa to the south-eastern corner of Section 367, then in a straight line across Goolwa Beach Road to the south-western corner of Section 368, Hundred of Goolwa, then in an easterly and northerly direction along the southern and eastern boundaries of Section 368, then in a northerly and westerly direction along the eastern and northern boundaries of Section 278, Hundred of Goolwa to the north-western corner of Section 278, then in a straight line across Goolwa Beach Road to the point of commencement.</p>	<p>6 p.m. on 31 December 2006 to 6 a.m. on 1 January 2007.</p>	<p>The consumption of liquor is prohibited and the possession of liquor is prohibited.</p>
<p>Alexandrina Council—Area 5 (Rotunda Reserve Area)</p>		
<p>(see Schedule 2: Alexandrina Council—Plan 5)</p>		
<p>Commencing at the northern corner of lot 167 then in a south-easterly direction along the north-eastern boundaries of lots 167, 171, 175 and 179 and the projection of that line across Hay Street to the boundary of part Section 271, then north-easterly along the north-western boundaries of part Section 271 and lot 2 in file plan 11114 and the projection of that line across The Cutting Road to the boundary of lot 3 in filed plan 11114, then north-westerly along the south-western boundary of part Section 271 and lot 190 then north-easterly along the north-western boundary of lot 190 and the projection of that boundary to the centre line of B.F. Laurie Lane, then north-westerly along the projection of the centreline to its intersection with the projection of the south-eastern boundary of lot 156, then south-westerly along that projection and boundary to the boundary of Section 215, then north-westerly along the boundary of Section 215 to its intersection with the boundary between lot 139 and Dawson Street then north-westerly along that boundary to the western corner of lot 139 then in a straight line across Section 215 to the point at which the boundary between lot 138 and Porter Street changes direction, then south-easterly along the north-eastern boundaries of lots 138, 147 and 155 and the projection of that boundary across Wildman Street to the northern corner of lot 166, then across Porter Street to the western corner of lot 167 then along the north-western boundary of lot 167 to the</p>	<p>6 p.m. on 31 December 2006 to 6 a.m. on 1 January 2007.</p>	<p>The consumption of liquor is prohibited and the possession of liquor is prohibited.</p>

Area	Period	Extent of prohibition
point of commencement.		
Alexandrina Council—Area 6 (Basham Beach Area)		
(see Schedule 2: Alexandrina Council—Plan 6)		
Commencing at the point at which the western boundary of Basham Beach Road, Middleton, intersects the southern boundary of the railway reserve for the Victor Harbor Tourist Railway, then south-easterly along that boundary of Basham Beach Road to the northern boundary of Lot 96 FP 166155, then south-westerly, south-easterly and north-easterly along the northern, western and southern boundaries of Lot 96 to the western boundary of Basham Beach Road, then south-easterly along that boundary of Basham Beach Road and the prolongation in a straight line of that boundary to the low water mark of Encounter Bay, then generally south-westerly, southerly, south-easterly, easterly, southerly, south-westerly and north-westerly along the low water mark to the prolongation in a straight line of the western boundary of Lot 2 DP 52281, then northerly along that prolongation and boundary of Lot 2 to the southern boundary of Lot 1 DP 52281 (the southern boundary of the Port Elliot Caravan Park), then generally easterly, south-easterly, north-easterly and northerly along that boundary of Lot 1 and the eastern boundary of Lot 858 FP 166107 to the northern boundary of Lot 858, then south-westerly along the northern boundary of Lot 858 and the northern boundaries of the adjoining allotments to the eastern boundary of the railway reserve for the Victor Harbor Tourist Railway, then generally north-easterly along that boundary of the railway reserve to the point of commencement.	6 p.m. on 31 December 2006 to 6 a.m. on 1 January 2007.	The consumption of liquor is prohibited and the possession of liquor is prohibited.
Beachport—Area 1		
(see Schedule 2: Beachport—Plan 1)		
The area hatched in Beachport—Plan 1 in Schedule 2.	12 noon on 31 December 2007 to 12 noon on 2 January 2008.	The consumption of liquor is prohibited and the possession of liquor is prohibited.
Glenelg—Area 1		
(see Schedule 2: Glenelg—Plan 1)		
The area in Glenelg bounded as follows: commencing at the point at which the eastern boundary of Colley Terrace intersects the northern boundary of Augusta Street, then generally easterly along the northern boundary of Augusta Street (including around the western, northern and eastern boundaries of Torrens Square) to its intersection with the eastern boundary of Brighton Road, then southerly along that boundary of Brighton Road to the northern boundary of Dunbar Terrace, then easterly along that boundary of Dunbar Terrace to the point at which it meets the western boundary of First Avenue, then	9 p.m. on 31 December 2007 to 6 a.m. on 1 January 2008.	The consumption of liquor is prohibited. The possession of liquor is prohibited, and the prohibition extends to possession in each of the circumstances referred to in

Liquor Licensing (Dry Areas—Short Term) Regulations 1997—29.11.2007 to 5.12.2007

Schedule 1—Short term dry areas

Area	Period	Extent of prohibition
<p>in a straight line by the shortest route (across Dunbar Terrace and Maxwell Terrace) to the point at which the southern boundary of Maxwell Terrace meets the eastern boundary of Fortrose Street, then westerly along that boundary of Maxwell Terrace to the eastern boundary of Brighton Road, then southerly along that boundary of Brighton Road to its intersection with the prolongation in a straight line of the southern boundary of High Street, then generally westerly along that prolongation and boundary of High Street to the point at which the prolongation in a straight line of that southern boundary of High Street intersects the western boundary of Moseley Street, then northerly along that boundary of Moseley Street to the southern boundary of College Street, then westerly along that boundary of College Street and the prolongation in a straight line of that boundary to the western boundary of St John's Row, then northerly along that boundary of St John's Row to the southern boundary of South Esplanade Lane (the northern boundary of Lot 101 FP 6859), then westerly along that boundary of South Esplanade Lane to the eastern boundary of the South Esplanade, then south-westerly along that boundary of the South Esplanade to the northern boundary of Kent Street, then westerly along that boundary of Kent Street and the prolongation in a straight line of that boundary to the low water mark of Gulf St Vincent, then generally northerly along the low water mark (including the low water mark around the outer boundary of any breakwater or groyne) to the entrance to the Patawalonga River, then generally south-easterly, easterly, northerly, easterly and northerly along the southern and eastern bank of the River to the point at which the eastern bank of the River intersects the prolongation in a straight line of the southern boundary of St Anne's Terrace, then easterly along that prolongation to the western boundary of Adelphi Terrace, then southerly along that western boundary of Adelphi Terrace and the prolongation in a straight line of that boundary to the southern boundary of Anzac Highway, then westerly along that boundary of Anzac Highway to the eastern boundary of Colley Terrace, then southerly along that boundary of Colley Terrace to the point of commencement. The area includes the Glenelg Jetty and any other jetty, wharf, mooring, dock or other structure (apart from the Patawalonga Weir) projecting into the Gulf or River from the area described above, as well as any area beneath such a structure.</p>		regulation 4(3).
<p>Murray Bridge—Area 1</p>	<p>5 p.m. on 18 November 2006 to 12 midnight on 18 November 2006.</p>	<p>The consumption of liquor is prohibited and the possession of liquor is prohibited.</p>
<p>(see Schedule 2: Murray Bridge—Plan 1)</p>		
<p>The area in Murray Bridge, comprising Sturt Reserve and adjacent areas, bounded as follows: commencing at the point at which the south-eastern boundary of Bridge Street meets the south-western edge of the River Murray, then generally south-easterly along that edge of the River to the point at which it intersects the prolongation in a straight line of the south-eastern boundary of the southern portion of Jaensch Road, then generally south-westerly, westerly and north-westerly along that prolongation and boundary of the southern portion of Jaensch Road and the prolongation in a straight line across Sturt Reserve Road of that boundary to the north-western boundary of Sturt Reserve Road,</p>		

Area	Period	Extent of prohibition
<p>then north-easterly along that boundary of Sturt Reserve Road to the western boundary of Lot 82 DP55455, then generally north-westerly and north-easterly along that boundary of Lot 82 to the western boundary of the northern portion of Jaensch Road, then generally north-easterly and north-westerly along that boundary of the northern portion of Jaensch Road and the south-western boundary of East Terrace to the point at which the south-western boundary of East Terrace meets the south-eastern boundary of Bridge Street, then generally north-easterly along that boundary of Bridge Street to the point of commencement. The area includes any wharf, jetty, boat ramp or other structure (other than a bridge across the River) extending into or over the waters of the River Murray from the area described above.</p> <p>Port Augusta—Area 1</p> <p>(see Schedule 2: Port Augusta—Plan 1)</p> <p>The area in Port Augusta, generally known as Central Oval, that is enclosed by a fence that, from the point at which the northern boundary of the Port Augusta TAFE SA Campus meets the north-eastern boundary of Victoria Parade, proceeds generally easterly, north-easterly, northerly, north-westerly, westerly, south-westerly and south-easterly (around the oval and trotting track that lies immediately to the north of the TAFE SA Campus and along the north-eastern boundary of Victoria Parade) back to the point of commencement.</p> <p>Port Vincent—Area 1</p> <p>(see Schedule 2: Port Vincent—Plan 1)</p> <p>The area in Port Vincent bounded as follows: commencing at the point at which the south-western boundary of Marine Parade meets the south-eastern boundary of Way Street, then south-easterly along that boundary of Marine Parade to the point at which it meets the south-eastern boundary of Curramulka Road, then north-easterly along the prolongation in a straight line of that boundary of Curramulka Road to the north-eastern boundary of Marine Parade, then south-easterly along that road boundary to the eastern boundary of Lot 7 (the western boundary of the entrance to the boat ramp), then northerly along that boundary of Lot 7 and the prolongation in a straight line of that boundary to the low water mark of Gulf St. Vincent, then generally north-westerly along the low water mark and around the outer boundary of any wharf or other structure extending into Gulf St. Vincent beyond the low water mark (so as to include the wharf or other structure within the area) to the point at which the low water mark intersects the prolongation in a straight line of the south-eastern boundary of Way Street, then south-westerly along that prolongation and boundary to the point of commencement, together with—</p>	<p>12.01 a.m. on 1 October 2005 to 12.01 a.m. on 4 October 2005.</p> <p>10 p.m. on each day to 8 a.m. on the following day, from 10 p.m. on 22 December 2007 to 8 a.m. on 2 January 2008.</p>	<p>The consumption of liquor is prohibited and the possession of liquor is prohibited.</p> <p>The consumption of liquor is prohibited and the possession of liquor is prohibited.</p>

Liquor Licensing (Dry Areas—Short Term) Regulations 1997—29.11.2007 to 5.12.2007

Schedule 1—Short term dry areas

Area	Period	Extent of prohibition
<p>(a) Cameron Street between the south-western boundary of Marine Parade and the south-western boundary of Germein Street; and</p> <p>(b) Germein Street between the north-western boundary of Cameron Street and north-western boundary of Main Street; and</p> <p>(c) Main Street between the south-western boundary of Germein Street and the south-western boundary of Marine Parade; and</p> <p>(d) Ramsay Street between the south-eastern boundary of Main Street and the south-eastern boundary of Curramulka Road; and</p> <p>(e) Curramulka Road between the south-western boundary of Ramsay Street and the south-western boundary of Marine Parade.</p>		
<p>Robe—Area 1</p>		
<p>(see Schedule 2: Robe—Plan 1, Area "A")</p>		
<p>The area in Robe known as Lipson Park, with adjacent land, bounded on the south by Sturt Street, on the east by Hagen Street, on the north by the prolongation (westerly) in a straight line of the southern boundary of Smillie Street, on the north-west by the low water mark on Lake Butler and on the west by the fence line of the adjoining private land.</p>	<p>1 p.m. on 31 December 2006 to 9 a.m. on 1 January 2007.</p>	<p>The consumption of liquor is prohibited and the possession of liquor is prohibited.</p>
<p>Robe—Area 2</p>		
<p>(see Schedule 2: Robe—Plan 1, Area "B")</p>		
<p>The area in Robe as follows: commencing at the point at which the north-easterly prolongation in a straight line of the eastern boundary of Lot 3 of DP 33446, Hundred of Waterhouse, intersects the low water mark, then generally easterly, south-easterly, easterly and north-easterly along the low water mark to the point at which the north-easterly prolongation in a straight line of the property line of the properties bordering the Town Beach intersects the low water mark (adjacent to Robe Point), then generally south-westerly and westerly along that prolongation and property line to the eastern boundary of Section 526, Hundred of Waterhouse, then generally south-westerly along that boundary of Section 526 and the prolongation in a straight line of that boundary to the southern boundary of Mundy Terrace, then generally north-westerly, westerly, south-westerly and north-westerly along that boundary of Mundy Terrace and Royal Circus to the point at which that boundary of Royal Circus meets the eastern boundary of Lot 4 of DP 33446, Hundred of Waterhouse (adjacent to Lipson Terrace), then north-easterly along that boundary of Lot 4 and of Lot 3 of DP 33446, Hundred of</p>	<p>1 p.m. on 31 December 2006 to 9 a.m. on 1 January 2007.</p>	<p>The consumption of liquor is prohibited and the possession of liquor is prohibited.</p>

Area	Period	Extent of prohibition
Waterhouse, to the point of commencement.		
Robe—Area 3		
(see Schedule 2: Robe—Plan 1, Area "C")		
The area in Robe (known as the Institute Reserve) bounded on the south by Smillie Street, on the west by Bagot Street and on the north-east by Mundy Terrace.	1 p.m. on 31 December 2006 to 9 a.m. on 1 January 2007.	The consumption of liquor is prohibited and the possession of liquor is prohibited.
Robe—Area 4		
(see Schedule 2: Robe—Plan 1, Area "D")		
The area in Robe (known as Lannam Park) bounded on the south by Main Road, on the east by the prolongation in a straight line of the eastern boundary of Robson Street, on the north by Ryan Terrace and on the west by Domaschenz Street.	1 p.m. on 31 December 2006 to 9 a.m. on 1 January 2007.	The consumption of liquor is prohibited and the possession of liquor is prohibited.
Robe—Area 5		
(see Schedule 2: Robe—Plan 2)		
The area in Robe (known as Long Beach Foreshore Reserve) as follows: commencing at the point at which the prolongation in a straight line of the western boundary of Laurel Terrace intersects the low water mark, then southerly along that prolongation to the northern boundary of the Esplanade, then generally south-westerly, north-westerly, south-westerly and north-westerly along that boundary of the Esplanade to the western boundary of Section 523, Hundred of Waterhouse, then generally northerly along that boundary and the prolongation in a straight line of that boundary to the low water mark, then generally north-easterly along the low water mark to the point of commencement.	1 p.m. on 31 December 2006 to 9 a.m. on 1 January 2007.	The consumption of liquor is prohibited and the possession of liquor is prohibited.
Spalding—Area 1		
(see Schedule 2: Spalding—Plan 1)		
The area at Spalding bounded as follows: commencing at the point at which the southern boundary of Davies Terrace meets the eastern boundary of the Spalding to Clare Road, then in a straight line by the shortest route (across the Spalding to Clare Road) to the point at which the southern boundary of Trelyn Road meets the western boundary of the Spalding to Clare Road, then generally north-westerly and northerly along that boundary of Trelyn Road to the point at which it meets the southern boundary of the Jamestown to Spalding Road, then in a straight line by the shortest route (across the Jamestown to Spalding Road) to the point on the northern boundary of the Jamestown to Spalding Road at which the western boundary of Lot 538 of Filed Plan No. 187050 meets the northern boundary of Lot 537 of	12 noon on 3 November 2007 to 12 noon on 4 November 2007.	The consumption of liquor is prohibited and the possession of liquor is prohibited.

Liquor Licensing (Dry Areas—Short Term) Regulations 1997—29.11.2007 to 5.12.2007

Schedule 1—Short term dry areas

Area	Period	Extent of prohibition
<p>Filed Plan No. 187049, then easterly, southerly, easterly and north-easterly along the southern and eastern boundaries of Lot 538 to the point at which the eastern boundary of that Lot (the western boundary of Main Street) intersects the prolongation in a straight line of the northern boundary of Lincoln Avenue, then south-easterly along that prolongation and boundary of Lincoln Avenue and the prolongation in a straight line of that boundary to the point at which it intersects the eastern boundary of Edgeware Avenue, then south-westerly along that boundary of Edgeware Avenue to the point at which it meets the northern boundary of Howley's Crossing Road, then generally south-easterly, north-easterly and southerly along that boundary of Howley's Crossing Road and the prolongation in a straight line of that boundary to the southern boundary of Borve Hill Road, then south-westerly and westerly along that boundary of Borve Hill Road to the eastern boundary of the Burra to Spalding Road, then in a straight line by the shortest route (across the Burra to Spalding Road) to the point at which the southern boundary of Davies Terrace meets the western boundary of the Burra to Spalding Road, then north-westerly along that southern boundary of Davies Terrace to the point of commencement.</p>		
<p>Tumby Bay—Area 1</p> <p>(see Schedule 2: Tumby Bay—Plan 1)</p> <p>Commencing at the point at which the prolongation of the northern boundary of Dutton Terrace intersects the low water mark, then south-easterly along the low water mark to its intersection with the prolongation of the southern boundary of Goode Avenue, then south-westerly along the prolongation of the southern boundary of Goode Avenue to its intersection with the western boundary of Tumby Terrace, then north-westerly and northerly along that boundary to its intersection with the northern boundary of Dutton Terrace, then easterly along the prolongation of the northern boundary of Dutton Terrace to the point of commencement.</p>	<p>6.00 p.m. on 10 January 2005 to 6.00 a.m. on 15 January 2005.</p>	<p>The consumption of liquor is prohibited and the possession of liquor is prohibited.</p>
<p>Victor Harbor—Area 1</p> <p>(see Schedule 2: Victor Harbor—Plan 1)</p> <p>The area in Victor Harbor bounded as follows: commencing at the point at which the north-western boundary of Hindmarsh Road intersects the southern bank of the Hindmarsh River, then along that bank of the Hindmarsh River to the low water mark of Encounter Bay, then generally south-westerly, southerly, westerly and south-westerly along the low water mark to the northern bank of the Inman River, then generally westerly along that bank of the Inman River to the eastern boundary of the Victor Harbor Beach Front Caravan Park, then north-easterly along that boundary to the western boundary of Inman Street, then north-westerly along that boundary of Inman Street and the prolongation in a straight line of that boundary to the north-western boundary of Victoria Street, then north-easterly</p>	<p>From 3 p.m. on 31 December 2007 to 8 a.m. on 1 January 2008.</p>	<p>The consumption of liquor is prohibited and the possession of liquor is prohibited.</p>

Area	Period	Extent of prohibition
<p>along that boundary of Victoria Street to its intersection with the western boundary of Torrens Street, then north-westerly and north-easterly along that boundary of Torrens Street to its intersection with the north-eastern boundary of Crozier Road, then north-westerly along that boundary of Crozier Road to its intersection with the south-eastern boundary of Acraman Street, then north-easterly along that boundary of Acraman Street and Carlyle Street to its intersection with the south-western boundary of Cornhill Road, then south-easterly along that boundary of Cornhill Road to the north-western boundary of Hindmarsh Road, then generally north-easterly along that boundary of Hindmarsh Road to the point of commencement.</p> <p>Victor Harbor—Area 2</p> <p>(see Schedule 2: Victor Harbor—Plan 2)</p> <p>The area in Victor Harbor bounded as follows: commencing at the point at which the north-western boundary of Hindmarsh Road intersects the southern bank of the Hindmarsh River, then along that bank of the Hindmarsh River to the low water mark of Encounter Bay, then generally south-westerly, southerly, westerly and south-westerly along the low water mark to the northern bank of the Inman River, then generally westerly along that bank of the Inman River to the eastern boundary of the Victor Harbor Beach Front Caravan Park, then north-easterly along that boundary to the western boundary of Inman Street, then north-westerly along that boundary of Inman Street and the prolongation in a straight line of that boundary to the north-western boundary of Victoria Street, then north-easterly along that boundary of Victoria Street to the point at which it meets the south-western boundary of George Main Road, then north-westerly along that boundary of George Main Road to the southern boundary of Barker Reserve, then generally westerly along that boundary of the Reserve to the south-eastern boundary of Bay Road, then generally north-easterly along that boundary of Bay Road (the north-western boundary of the Reserve) to the point at which it meets the outer boundary of the roundabout at the intersection between Bay Road and George Main Road, then generally south-easterly and north-easterly around that boundary of the roundabout to the south-western boundary of George Main Road, then in a straight line by the shortest route across George Main Road to the north-eastern boundary of that road, then south-easterly along that boundary of George Main Road to the north-western boundary of Victoria Street, then north-easterly along that boundary of Victoria Street to the north-eastern boundary of Oval Road, then generally northerly and north-westerly along that boundary of Oval Road to the south-eastern boundary of Lindsay Street, then north-easterly along that boundary of Lindsay Street and the south-eastern boundaries of Acraman Street and Carlyle Street to the point at which the south-eastern boundary of Carlyle Street intersects the south-western boundary of Cornhill Road, then south-easterly along that boundary of Cornhill Road to the north-western boundary of Hindmarsh Road, then generally north-easterly along that boundary of Hindmarsh Road to the point of commencement.</p>	<p>From 8 a.m. on 23 November 2007 to 10 p.m. on 1 December 2007.</p>	<p>The consumption of liquor is prohibited and the possession of liquor is prohibited.</p>

Liquor Licensing (Dry Areas—Short Term) Regulations 1997—29.11.2007 to 5.12.2007
Schedule 1—Short term dry areas

Area	Period	Extent of prohibition
Victor Harbor—Area 3		
(there is no plan for this area)		
The whole of Granite Island (to low water mark) and the whole of the causeway linking Granite Island to the mainland.	(a)	From 8 a.m. on 23 November 2007 to 10 p.m. on 1 December 2007;
	(b)	From 3 p.m. on 31 December 2007 to 8 a.m. on 1 January 2008.

Schedule 2—Plans of short term dry areas

Alexandrina Council—Plan 1 (Chiton Rocks)

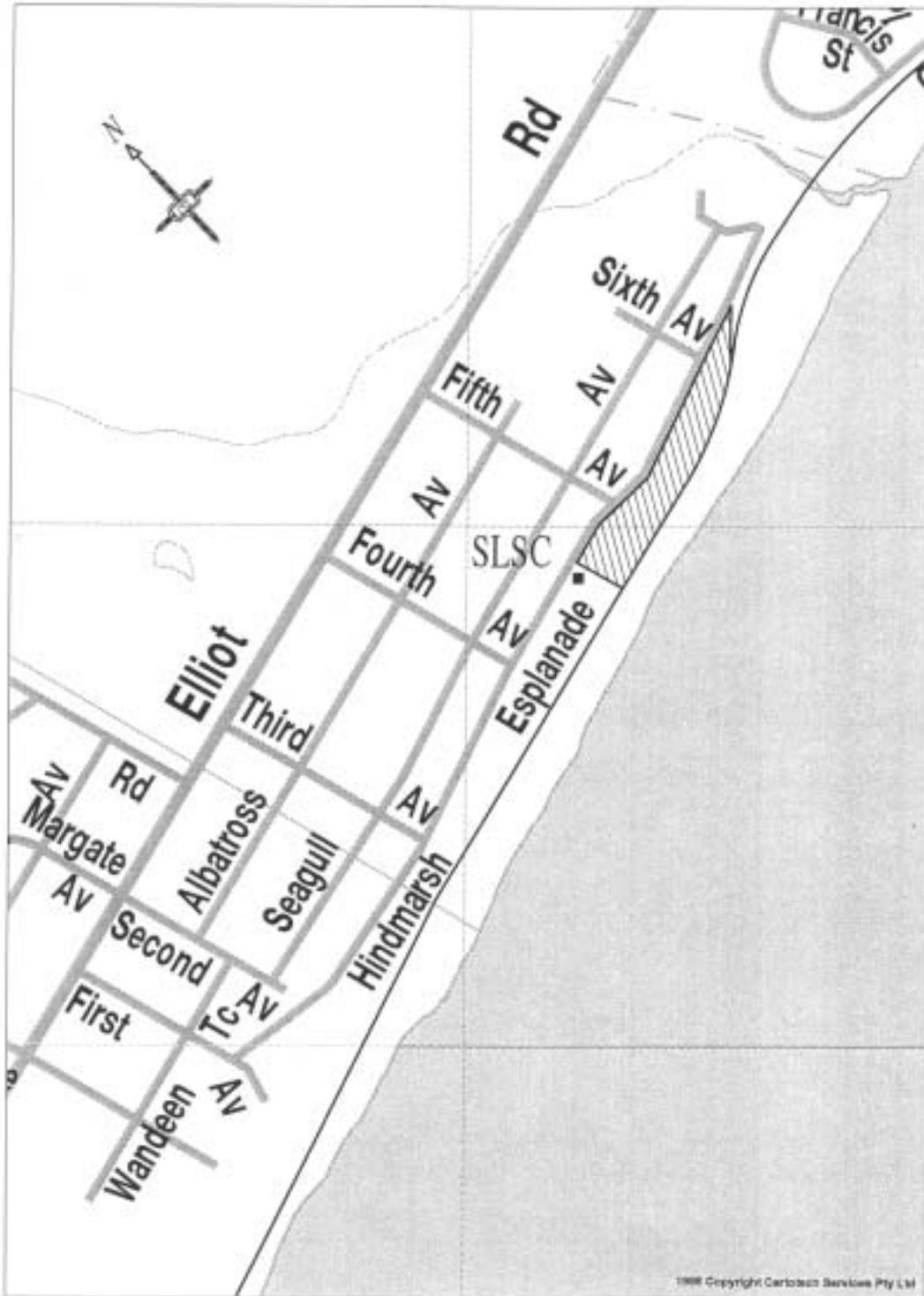

Alexandrina Council—Plan 2 (Port Elliot)

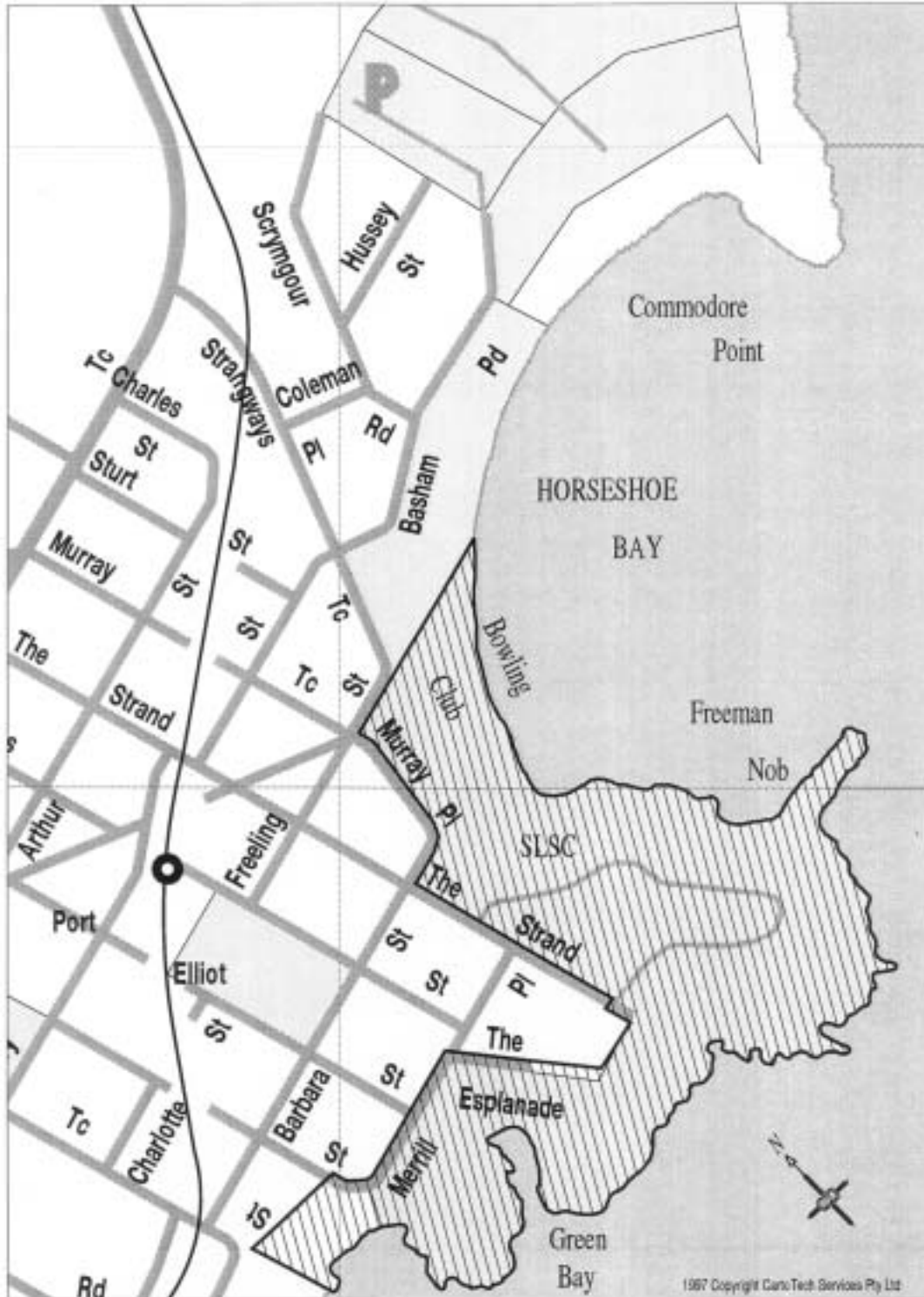

Alexandrina Council—Plan 3 (Middleton)

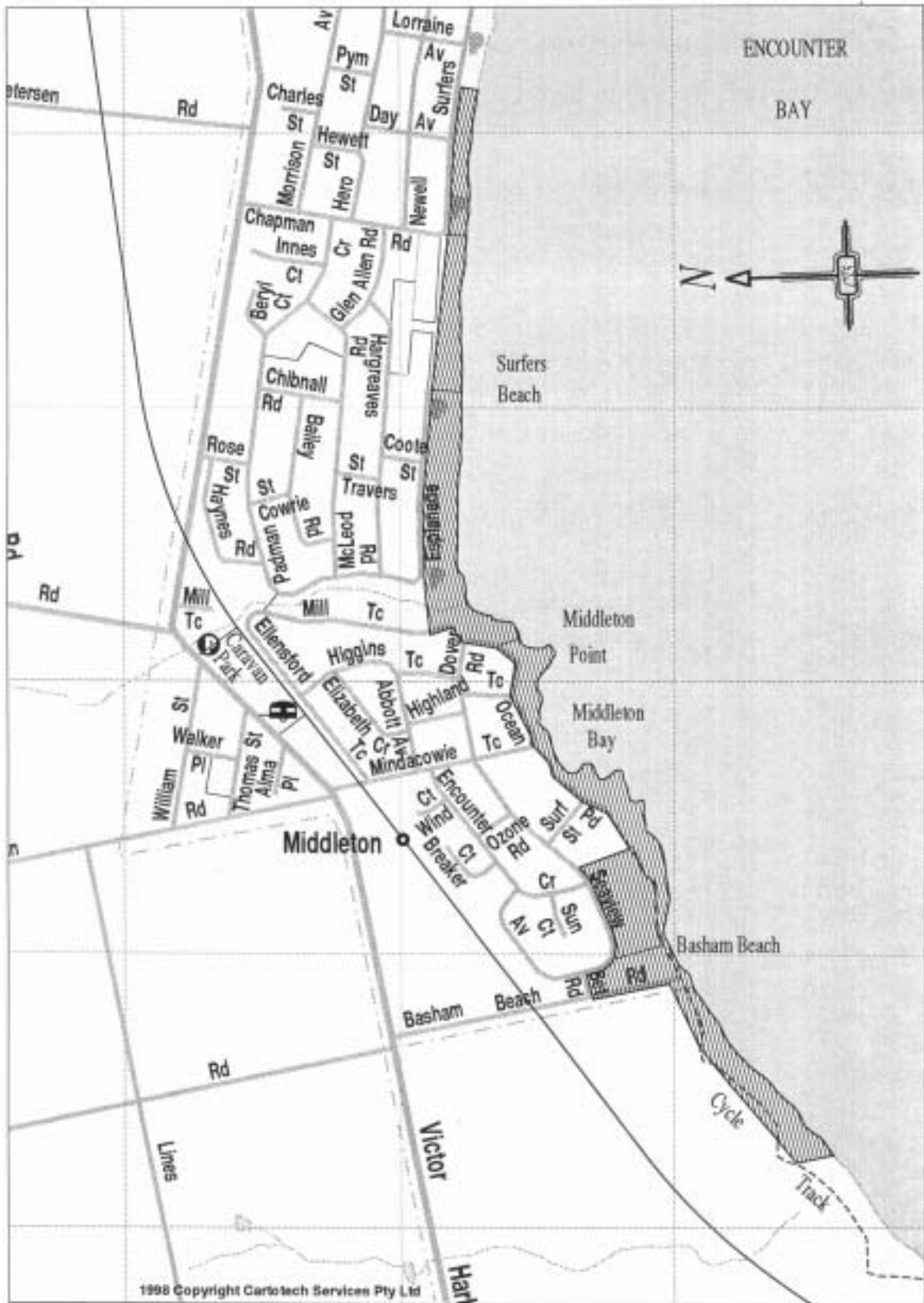

Alexandrina Council—Plan 4 (Goolwa Beach Carpark)

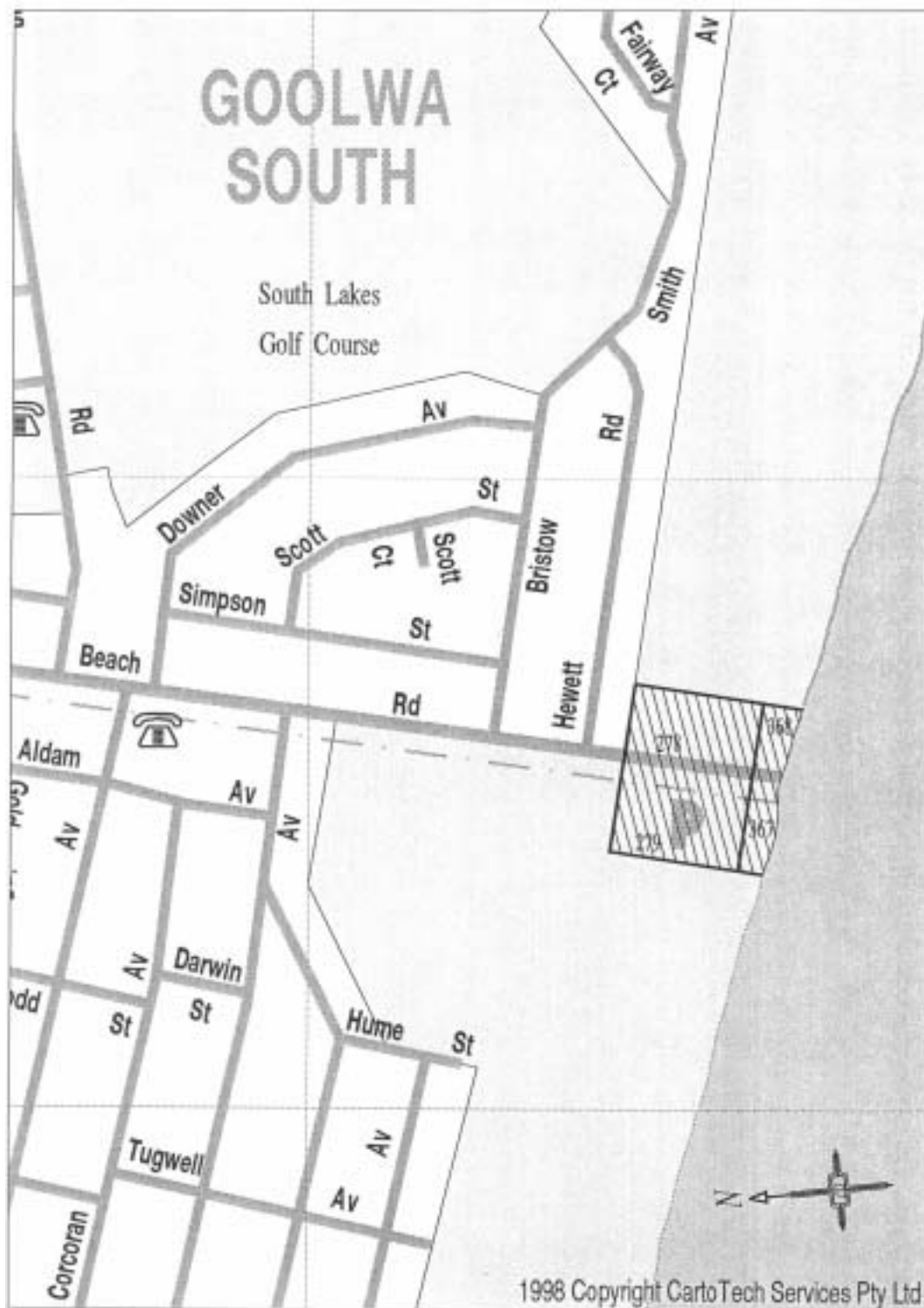

Alexandrina Council—Plan 5 (Rotunda Reserve Area)



Alexandrina Council—Plan 6

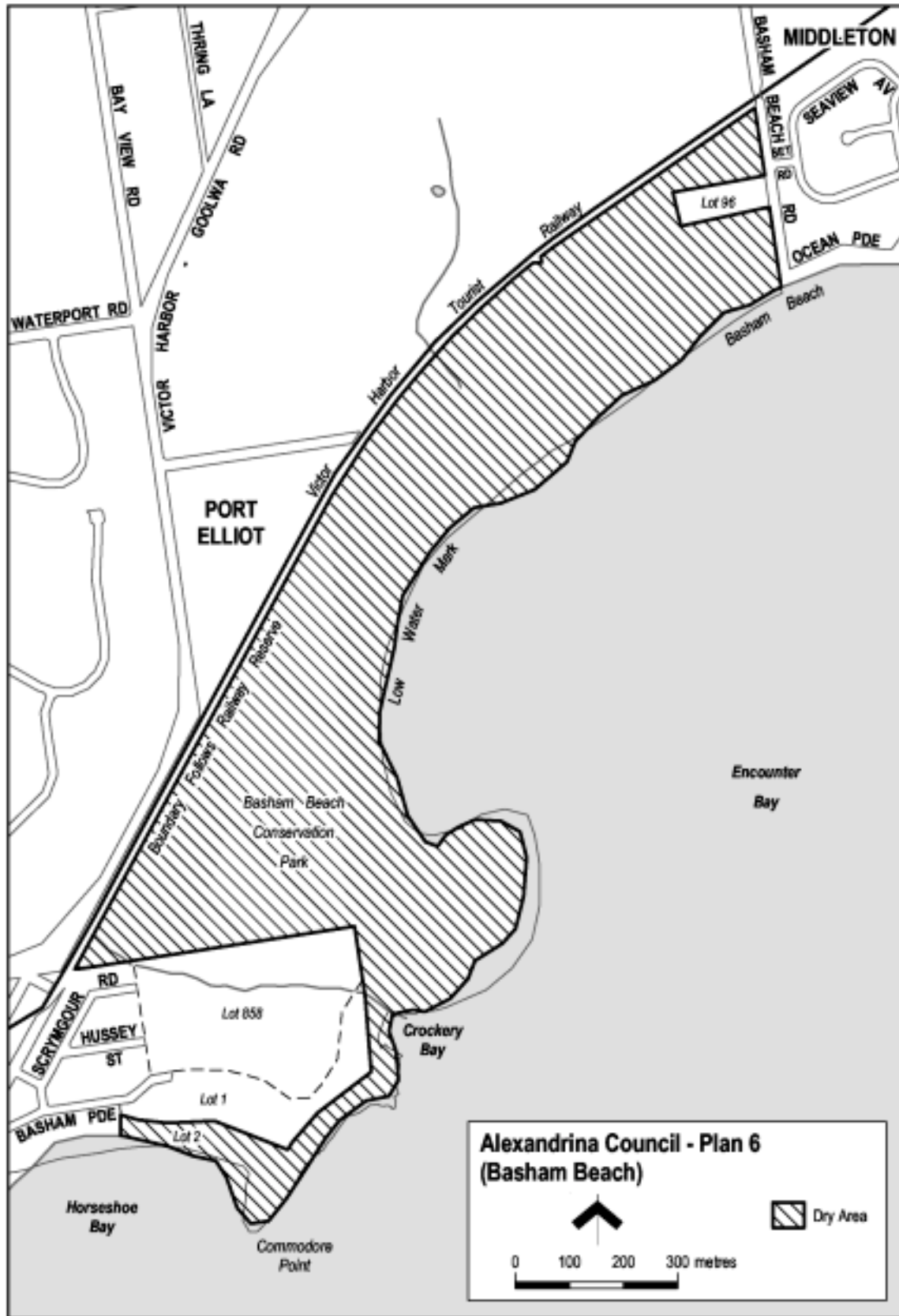

Beachport—Plan 1

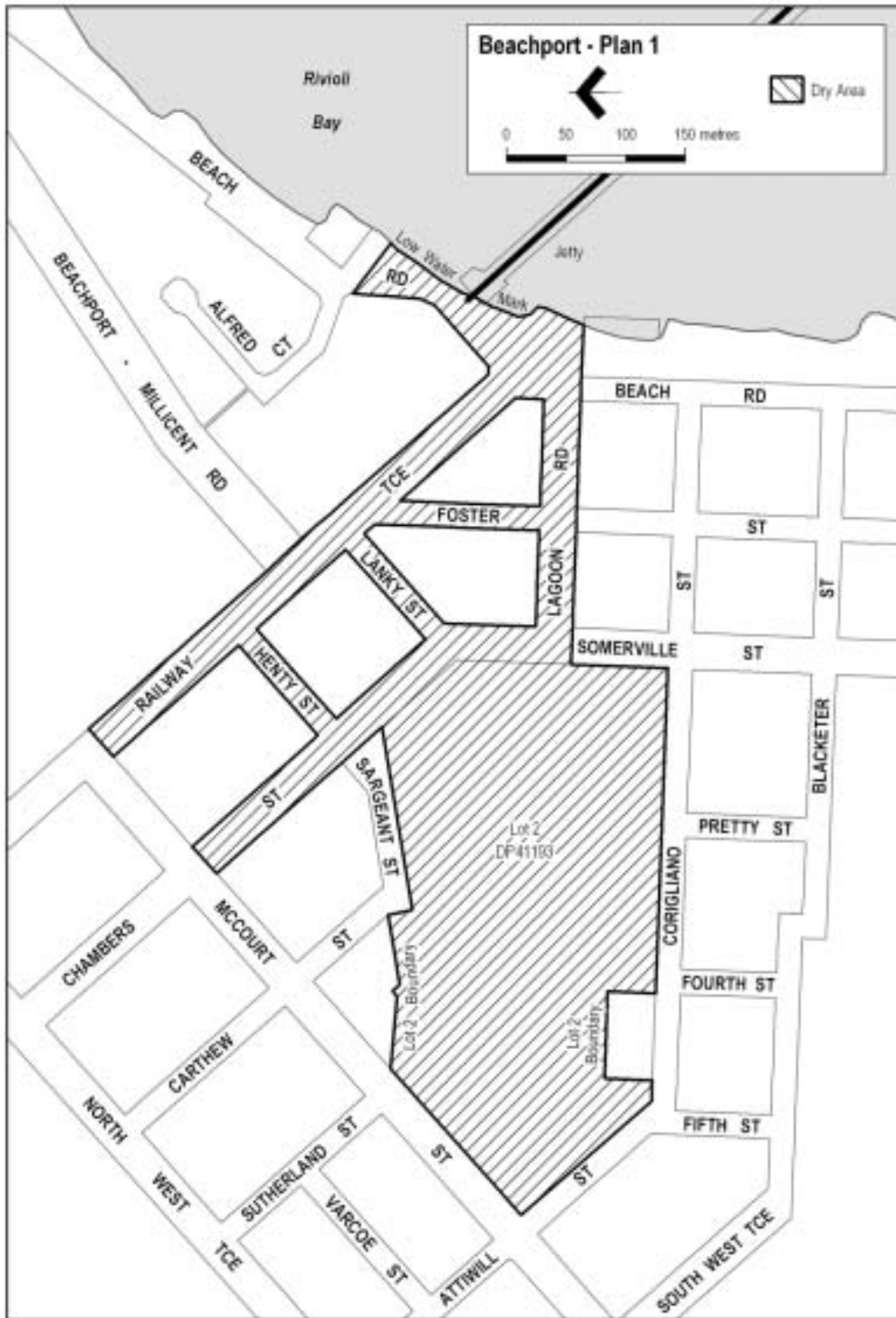

Glenelg—Plan 1

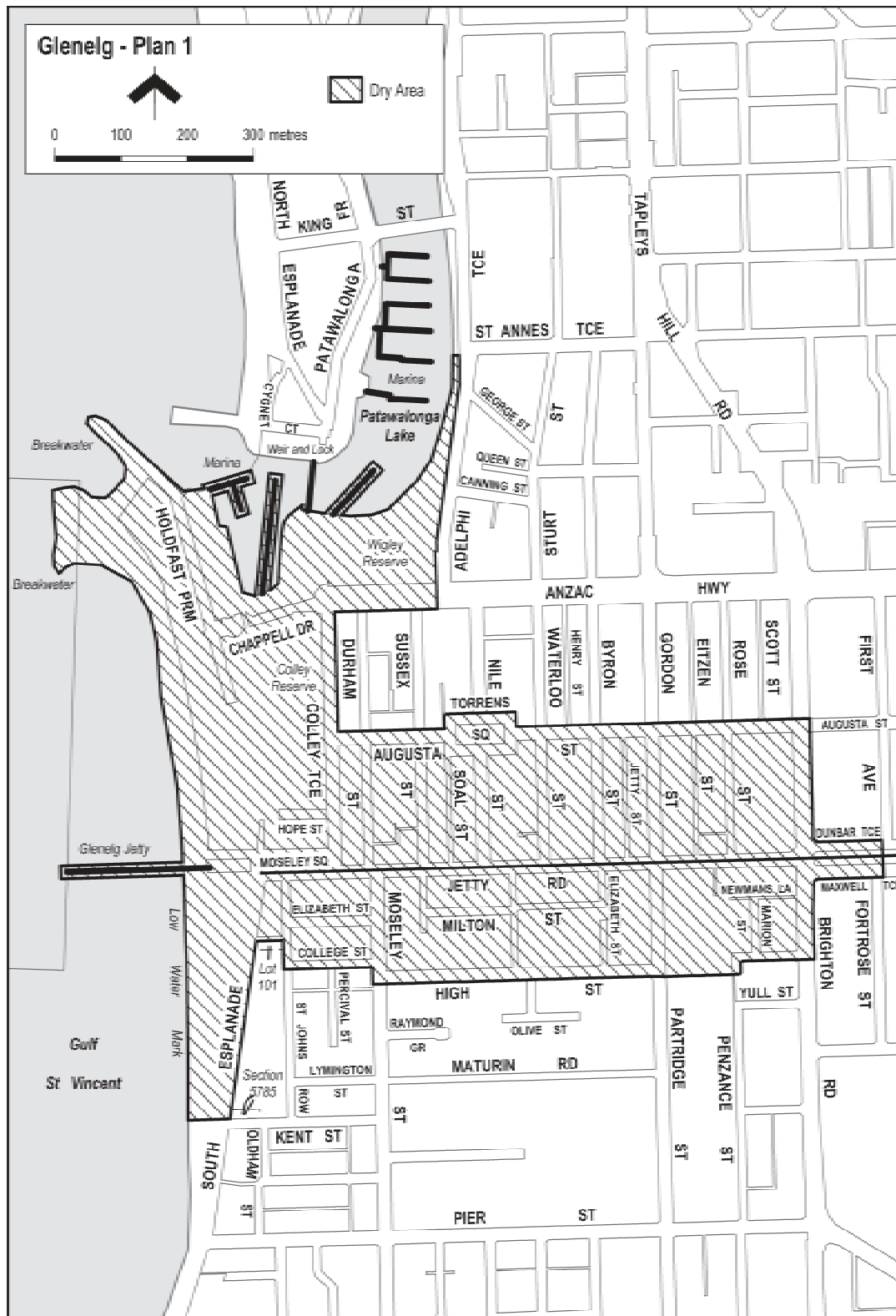

Murray Bridge—Plan 1

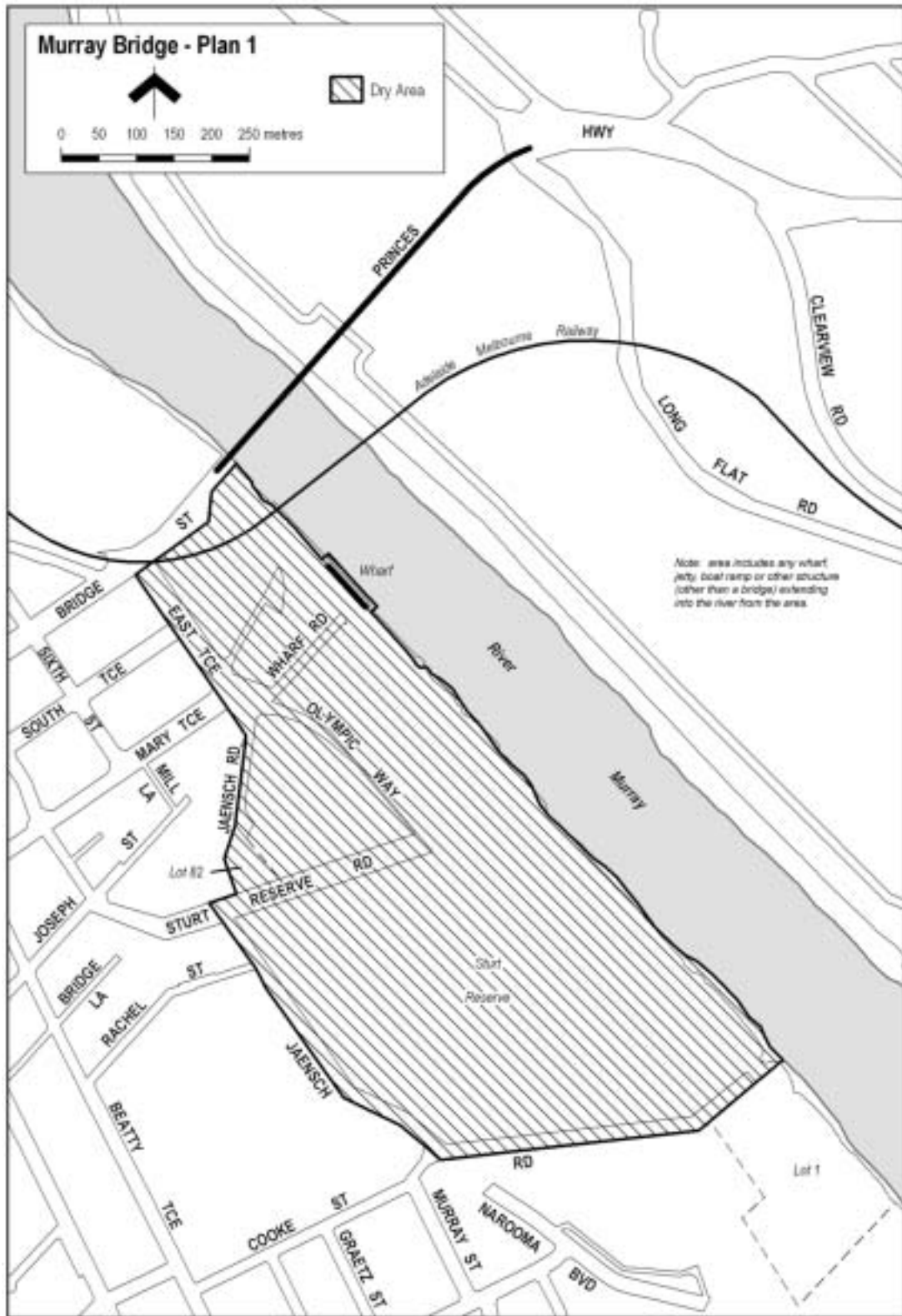

Port Augusta—Plan 1

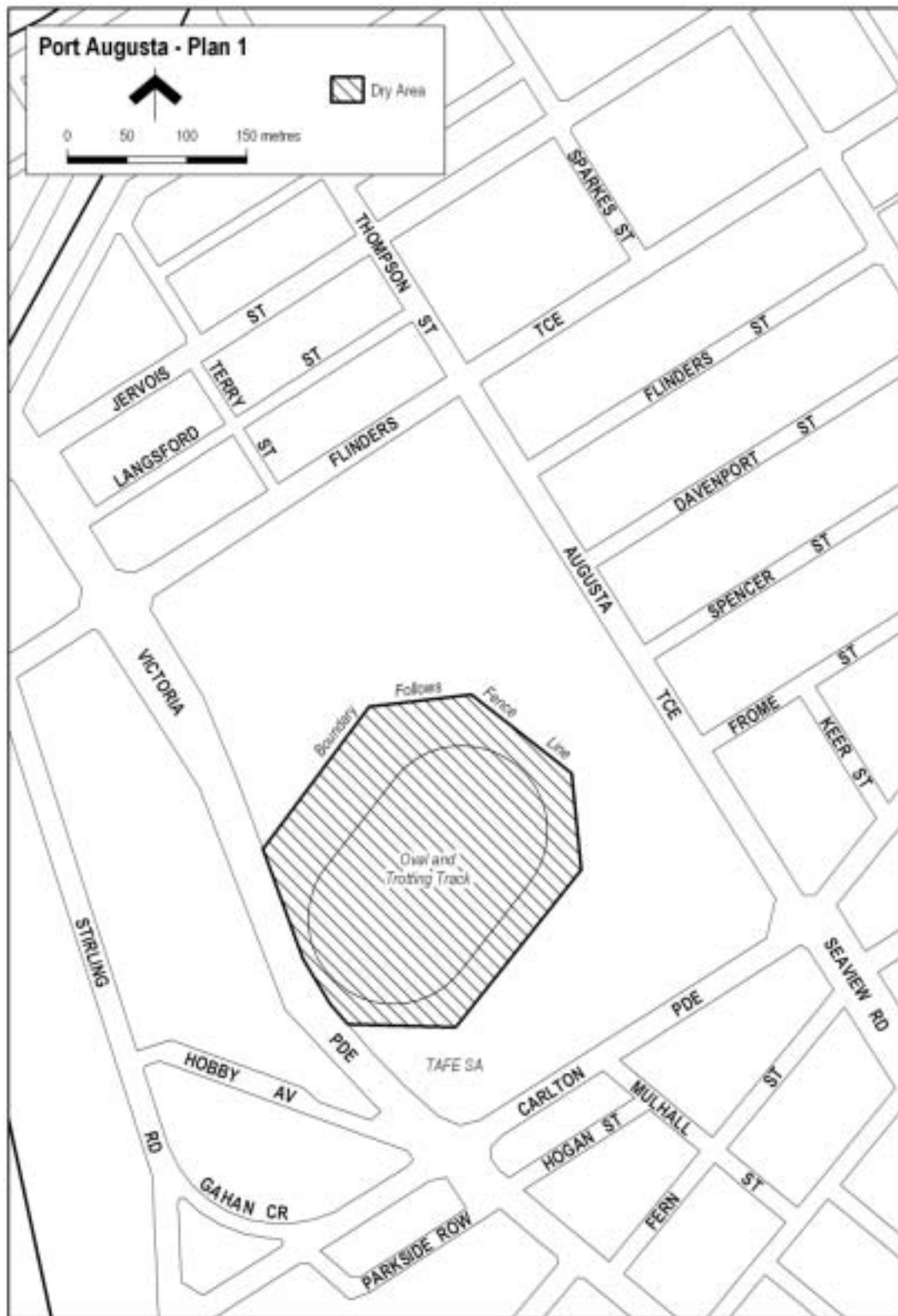

Port Vincent—Plan 1

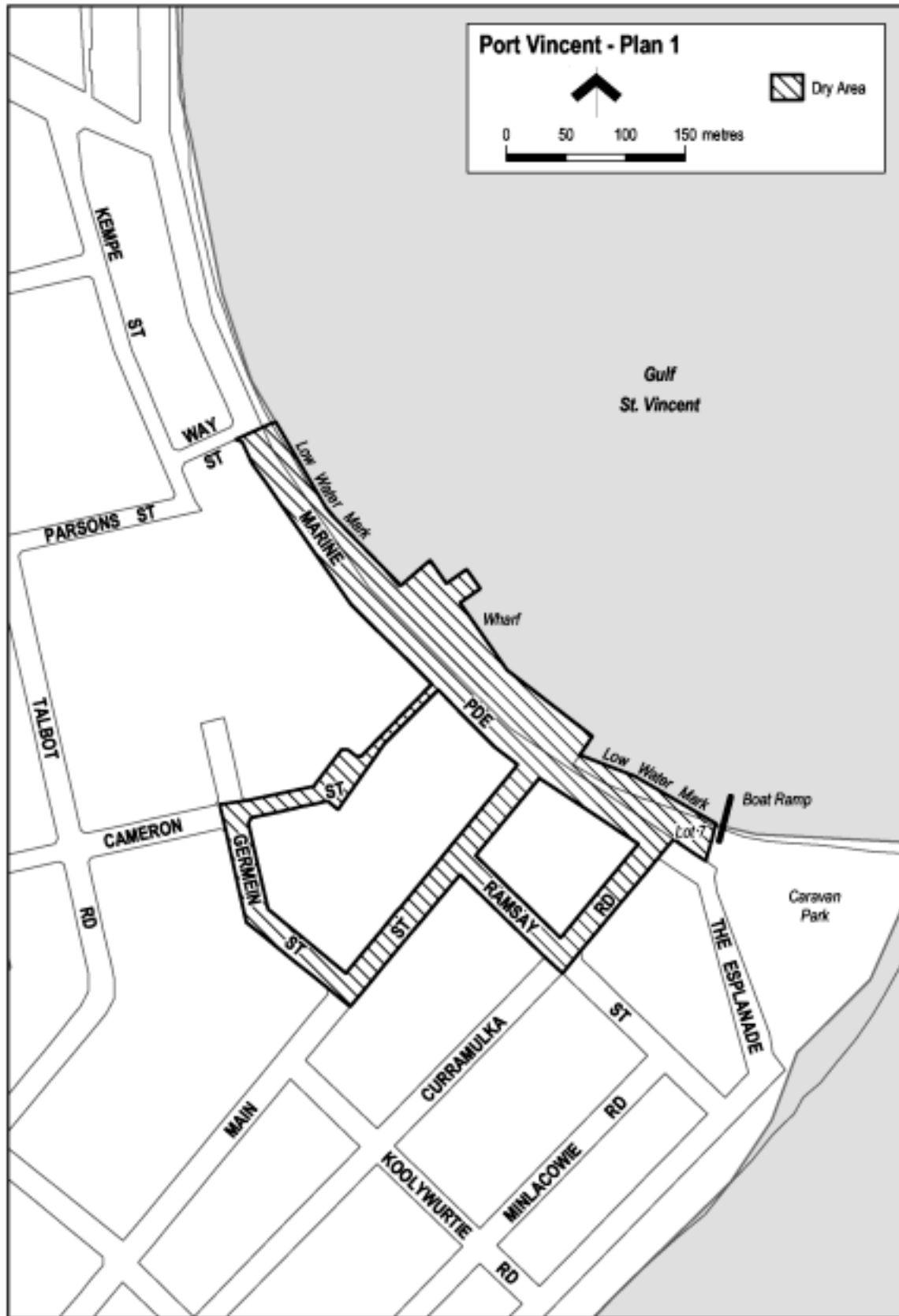

Robe—Plan 1

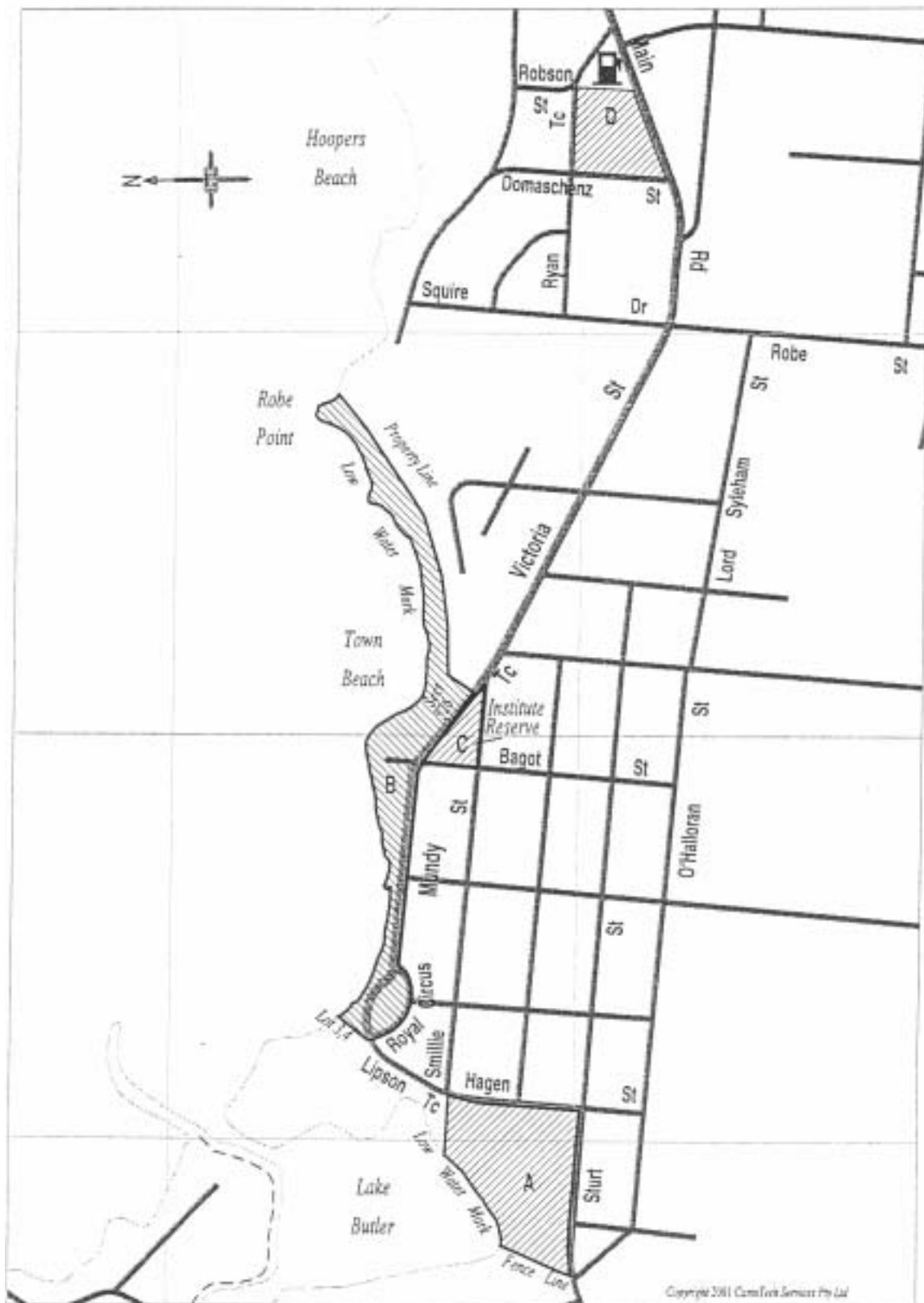

Robe—Plan 2

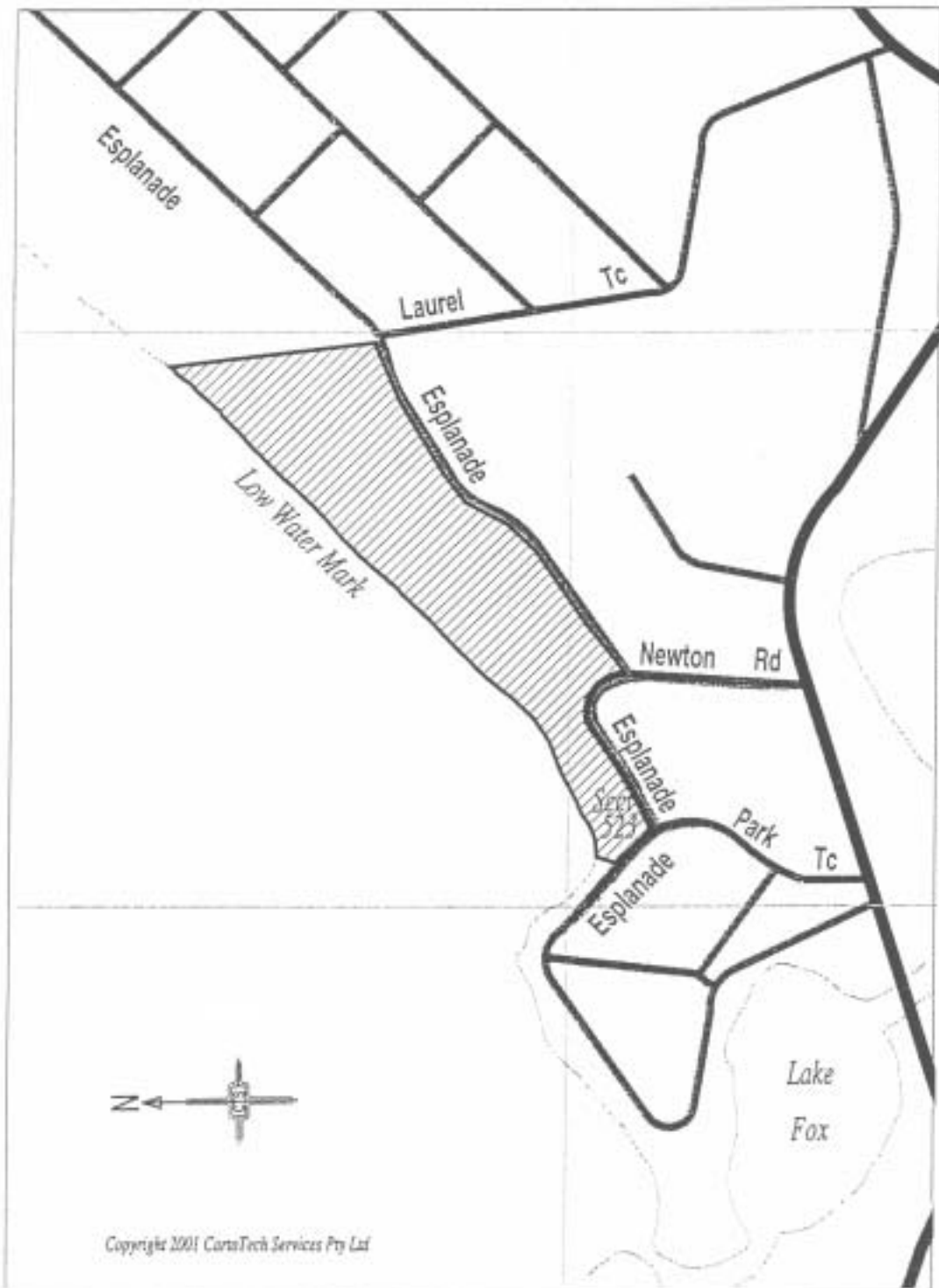

Spalding—Plan 1

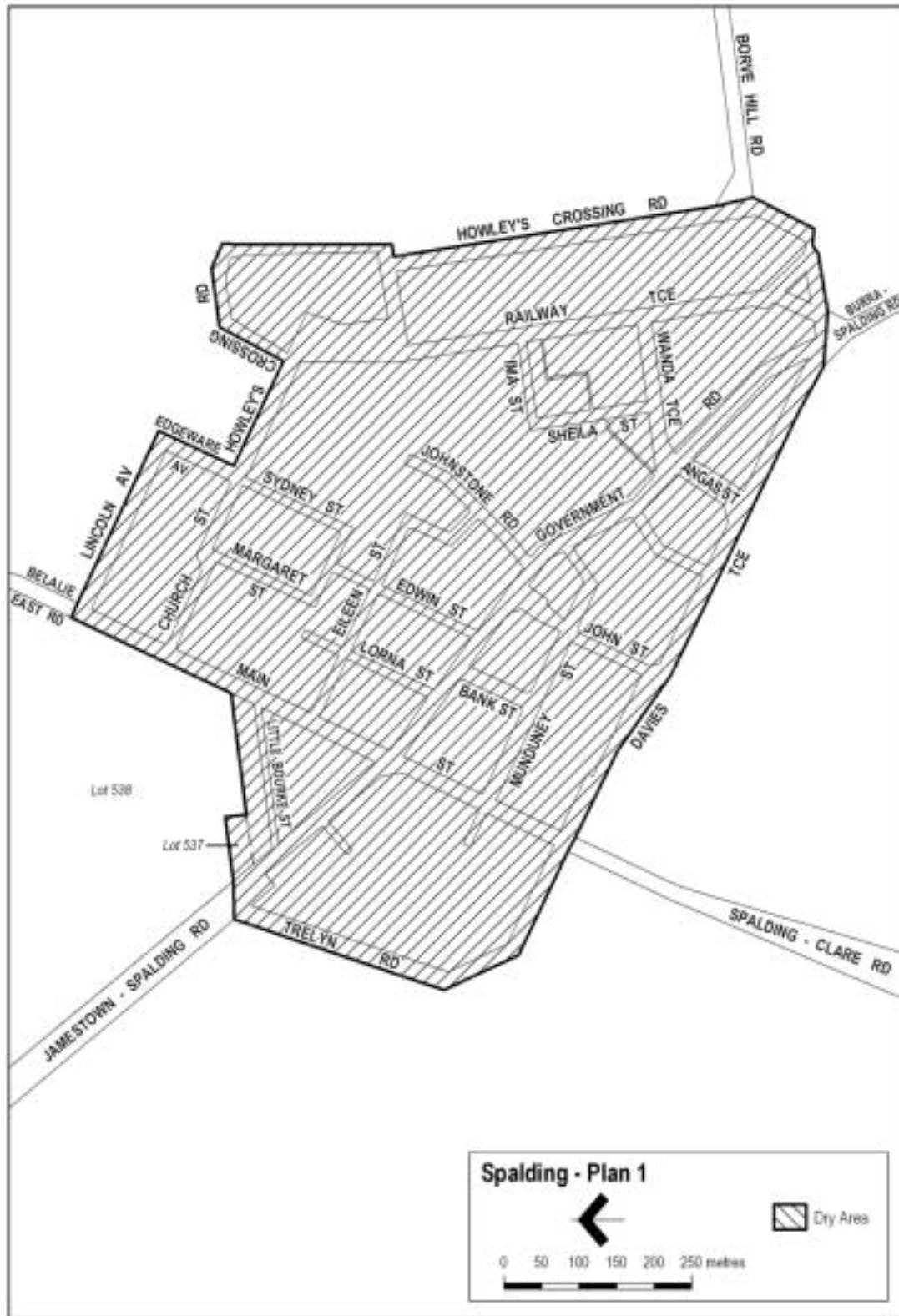

Tumby Bay—Plan 1

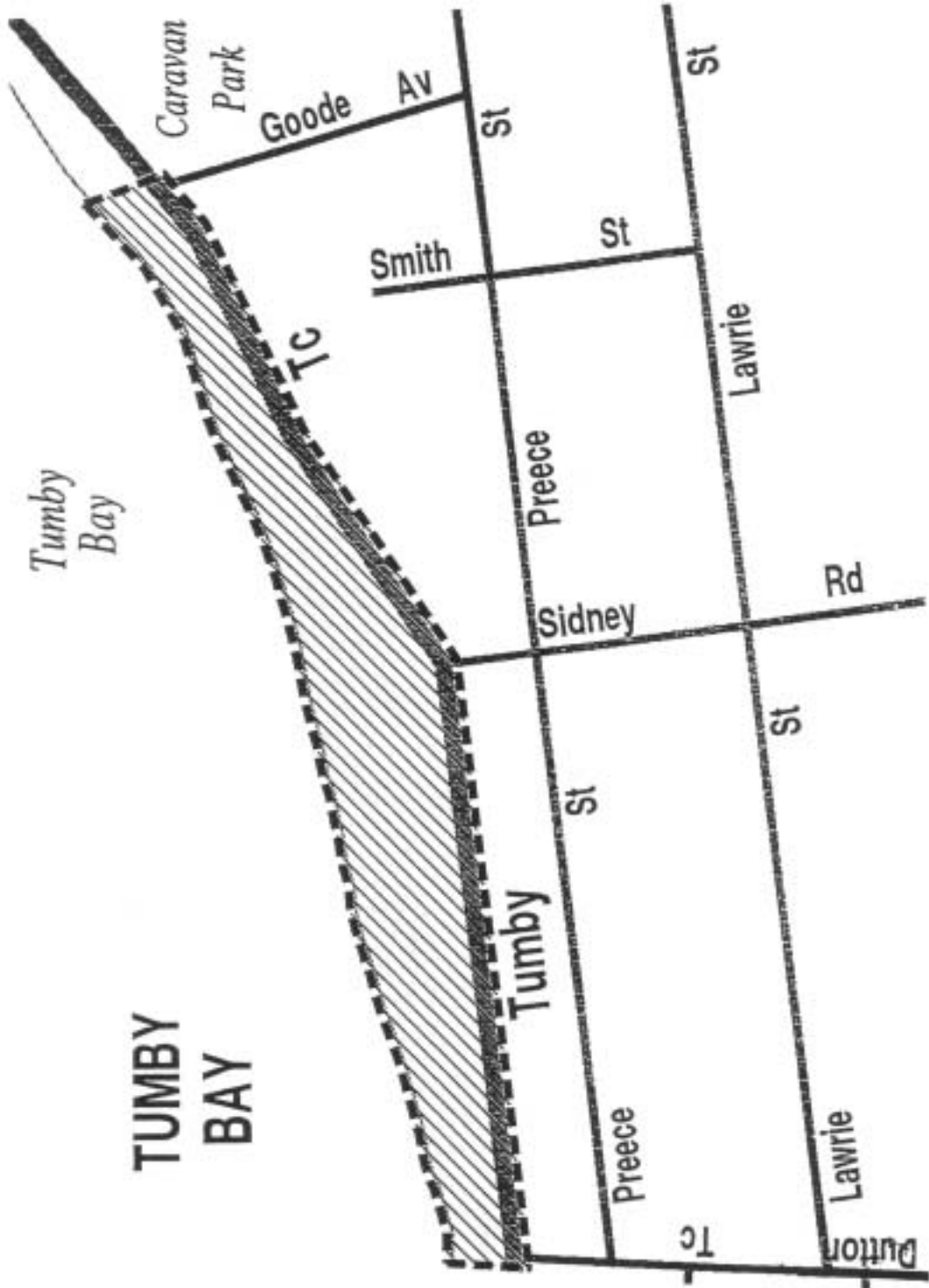

Victor Harbor—Plan 1

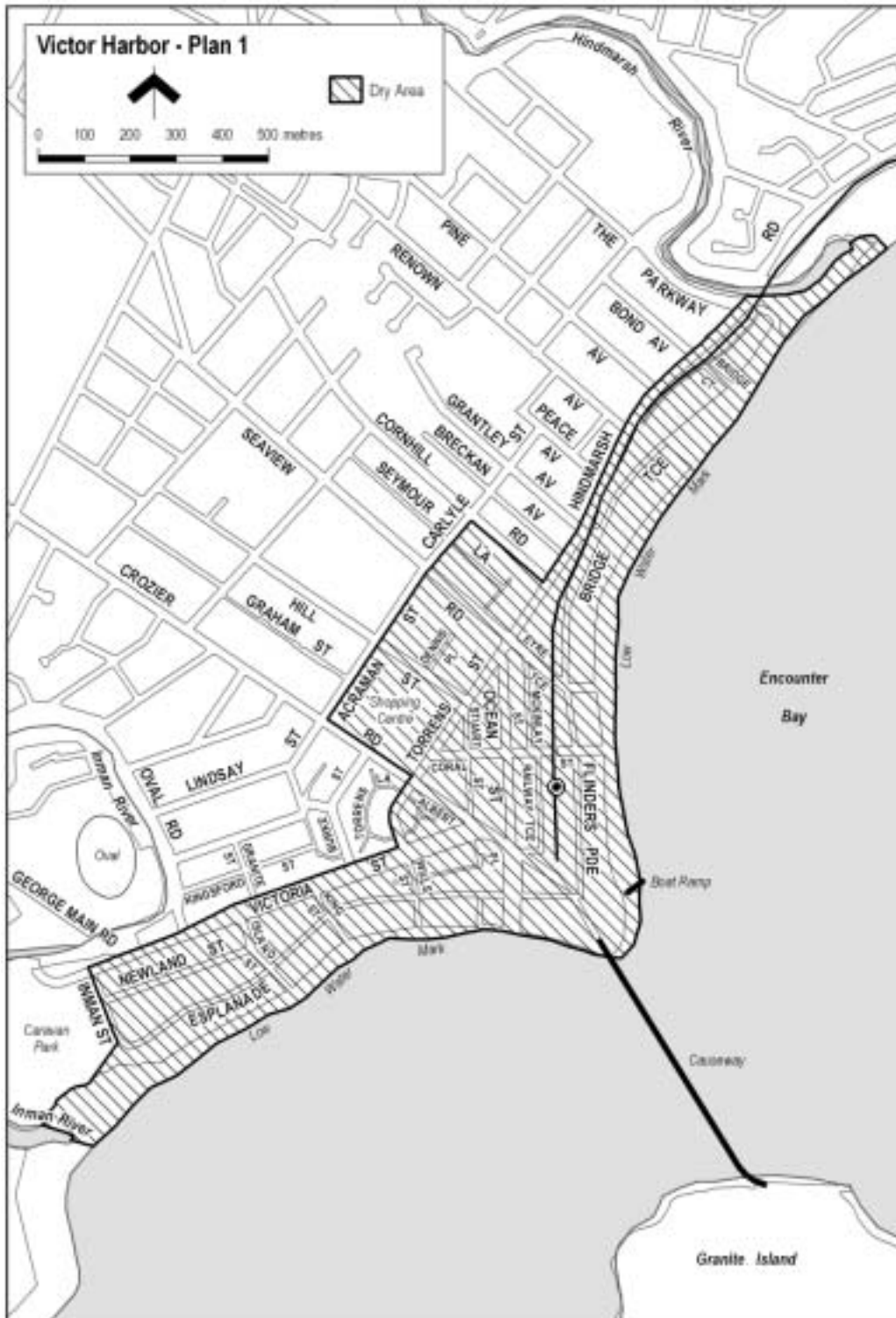

Victor Harbor—Plan 2



Legislative history

Notes

- Please note—References in the legislation to other legislation or instruments or to titles of bodies or offices are not automatically updated as part of the program for the revision and publication of legislation and therefore may be obsolete.
- Earlier versions of these regulations (historical versions) are listed at the end of the legislative history.
- For further information relating to the Act and subordinate legislation made under the Act see the Index of South Australian Statutes or www.legislation.sa.gov.au.

Principal regulations and variations

New entries appear in bold.

Year	No	Reference	Commencement
1997	212	<i>Gazette 2.10.1997 p965</i>	2.10.1997: r 2
1997	252	<i>Gazette 24.12.1997 p1817</i>	24.12.1997: r 2
1998	215	<i>Gazette 17.12.1998 p1978</i>	17.12.1998: r 2
1999	196	<i>Gazette 30.9.1999 p1386</i>	30.9.1999: r 2
1999	260	<i>Gazette 16.12.1999 p3474</i>	16.12.1999: r 2
2000	244	<i>Gazette 12.10.2000 p2489</i>	12.10.2000: r 2
2000	292	<i>Gazette 21.12.2000 p3775</i>	21.12.2000: r 2
2001	267	<i>Gazette 20.12.2001 p5660</i>	20.12.2001: r 2
2002	175	<i>Gazette 29.8.2002 p3279</i>	29.8.2002: r 2
2002	215	<i>Gazette 14.11.2002 p4209</i>	14.11.2002: r 2
2002	235	<i>Gazette 19.12.2002 p4823</i>	19.12.2002: r 2
2002	236	<i>Gazette 19.12.2002 p4824</i>	19.12.2002: r 2
2003	224	<i>Gazette 6.11.2003 p4012</i>	6.11.2003: r 2
2003	228	<i>Gazette 20.11.2003 p4206</i>	20.11.2003: r 2
2003	252	<i>Gazette 18.12.2003 p4571</i>	18.12.2003: r 2
2003	258	<i>Gazette 18.12.2003 p4594</i>	18.12.2003: r 2
2003	265	<i>Gazette 18.12.2003 p4631</i>	18.12.2003: r 2
2003	270	<i>Gazette 18.12.2003 p4661</i>	18.12.2003: r 2
2004	236	<i>Gazette 11.11.2004 p4307</i>	11.11.2004: r 2
2004	255	<i>Gazette 16.12.2004 p4617</i>	16.12.2004: r 2
2005	190	<i>Gazette 1.9.2005 p3215</i>	1.9.2005: r 2
2005	241	<i>Gazette 17.11.2005 p3984</i>	17.11.2005: r 2
2005	272	<i>Gazette 15.12.2005 p4334</i>	15.12.2005: r 2
2006	236	<i>Gazette 19.10.2006 p3755</i>	19.10.2006: r 2
2006	247	<i>Gazette 9.11.2006 p3960</i>	9.11.2006: r 2
2006	252	<i>Gazette 16.11.2006 p4010</i>	16.11.2006: r 2
2006	260	<i>Gazette 7.12.2006 p4277</i>	7.12.2006: r 2

2006	261	<i>Gazette 7.12.2006 p4279</i>	7.12.2006: r 2
2006	262	<i>Gazette 7.12.2006 p4281</i>	7.12.2006: r 2
2006	265	<i>Gazette 7.12.2006 p4289</i>	7.12.2006: r 2
2006	266	<i>Gazette 7.12.2006 p4291</i>	7.12.2006: r 2
2006	277	<i>Gazette 14.12.2006 p4411</i>	14.12.2006: r 2
2007	232	<i>Gazette 20.9.2007 p3750</i>	20.9.2007: r 2
2007	251	<i>Gazette 1.11.2007 p4146</i>	1.11.2007: r 2
2007	257	<i>Gazette 15.11.2007 p4246</i>	15.11.2007: r 2
2007	258	<i>Gazette 15.11.2007 p4249</i>	15.11.2007: r 2
2007	272	<i>Gazette 29.11.2007 p4411</i>	29.11.2007: r 2

Provisions varied

New entries appear in bold.

Entries that relate to provisions that have been deleted appear in italics.

Provision	How varied	Commencement
<i>r 2</i>	<i>omitted under the Legislation Revision and Publication Act 2002</i>	<i>11.11.2004</i>
r 5	inserted by 252/1997 r 3	24.12.1997
Sch 1		
<i>Adelaide—Area 1</i>	<i>deleted by 255/2004 r 4(1)</i>	<i>16.12.2004</i>
<i>Adelaide—Area 2</i>	<i>inserted by 252/1997 r 4</i>	<i>24.12.1997</i>
	<i>varied by 215/1998 r 3(a)</i>	<i>17.12.1998</i>
	<i>substituted by 260/1999 r 3(a)</i>	<i>16.12.1999</i>
	<i>deleted by 255/2004 r 4(1)</i>	<i>16.12.2004</i>
Adelaide—Area 1	inserted by 277/2006 r 4	14.12.2006
Alexandrina Council—Area 1	inserted by 252/1997 r 4	24.12.1997
	varied by 215/1998 r 3(b)	17.12.1998
	varied by 260/1999 r 3(b)	16.12.1999
	varied by 292/2000 r 3(a)	21.12.2000
	varied by 267/2001 r 3(a)	20.12.2001
	varied by 236/2002 r 3(a)	19.12.2002
	varied by 258/2003 r 4(1)	18.12.2003
	varied by 255/2004 r 4(2)	16.12.2004
	varied by 272/2005 r 4(1)	15.12.2005
	varied by 261/2006 r 4(1)	7.12.2006
Alexandrina Council—Area 2	inserted by 252/1997 r 4	24.12.1997
	varied by 215/1998 r 3(c)	17.12.1998
	varied by 260/1999 r 3(c)	16.12.1999
	varied by 292/2000 r 3(b)	21.12.2000
	varied by 267/2001 r 3(b)	20.12.2001
	varied by 236/2002 r 3(b)	19.12.2002

Liquor Licensing (Dry Areas—Short Term) Regulations 1997—29.11.2007 to 5.12.2007

Legislative history

	varied by 258/2003 r 4(2)	18.12.2003
	varied by 255/2004 r 4(3)	16.12.2004
	varied by 272/2005 r 4(2)	15.12.2005
	varied by 261/2006 r 4(2)	7.12.2006
Alexandrina Council—Area 3	inserted by 252/1997 r 4	24.12.1997
	varied by 215/1998 r 3(d)	17.12.1998
	varied by 260/1999 r 3(d)	16.12.1999
	varied by 292/2000 r 3(c)	21.12.2000
	varied by 267/2001 r 3(c)	20.12.2001
	varied by 236/2002 r 3(c)	19.12.2002
	varied by 258/2003 r 4(3)	18.12.2003
	varied by 255/2004 r 4(4)	16.12.2004
	varied by 272/2005 r 4(3)	15.12.2005
	varied by 261/2006 r 4(3)	7.12.2006
Alexandrina Council—Area 4	inserted by 252/1997 r 4	24.12.1997
	varied by 215/1998 r 3(e)	17.12.1998
	varied by 260/1999 r 3(e)	16.12.1999
	varied by 292/2000 r 3(d)	21.12.2000
	varied by 267/2001 r 3(d)	20.12.2001
	varied by 236/2002 r 3(d)	19.12.2002
	varied by 258/2003 r 4(4)	18.12.2003
	varied by 255/2004 r 4(5)	16.12.2004
	varied by 272/2005 r 4(4)	15.12.2005
	varied by 261/2006 r 4(4)	7.12.2006
Alexandrina Council—Area 5	inserted by 252/1997 r 4	24.12.1997
	varied by 215/1998 r 3(f)	17.12.1998
	varied by 260/1999 r 3(f)	16.12.1999
	varied by 292/2000 r 3(e)	21.12.2000
	varied by 267/2001 r 3(e)	20.12.2001
	varied by 236/2002 r 3(e)	19.12.2002
	varied by 258/2003 r 4(5)	18.12.2003
	varied by 255/2004 r 4(6)	16.12.2004
	varied by 272/2005 r 4(5)	15.12.2005
	varied by 261/2006 r 4(5)	7.12.2006
Alexandrina Council—Area 6	inserted by 255/2004 r 4(7)	16.12.2004
	varied by 272/2005 r 4(6)	15.12.2005
	varied by 261/2006 r 4(6)	7.12.2006
Beachport—Area 1	inserted by 252/1997 r 4	24.12.1997
	substituted by 215/1998 r 3(g)	17.12.1998
	varied by 260/1999 r 3(g)	16.12.1999

	varied by 292/2000 r 3(f)	21.12.2000
	varied by 267/2001 r 3(f)	20.12.2001
	varied by 236/2002 r 3(f)	19.12.2002
	varied by 265/2003 r 4	18.12.2003
	varied by 255/2004 r 4(8)	16.12.2004
	varied by 272/2005 r 4(7)	15.12.2005
	varied by 265/2006 r 4	7.12.2006
	substituted by 257/2007 r 4	15.11.2007
Glenelg—Area 1	inserted by 215/1998 r 3(g)	17.12.1998
	substituted by 260/1999 r 3(h)	16.12.1999
	varied by 292/2000 r 3(g)	21.12.2000
	varied by 267/2001 r 3(g)	20.12.2001
	varied by 236/2002 r 3(g)	19.12.2002
	varied by 258/2003 r 4(6)	18.12.2003
	varied by 255/2004 r 4(9)	16.12.2004
	varied by 272/2005 r 4(8), (9)	15.12.2005
	varied by 266/2006 r 4(1), (2)	7.12.2006
	varied by 258/2007 r 4	15.11.2007
Murray Bridge— Area 1	inserted by 252/2006 r 4	16.11.2006
Millicent—Area 1	<i>inserted by 260/1999 r 3(h)</i>	<i>16.12.1999</i>
	<i>deleted by 255/2004 r 4(10)</i>	<i>16.12.2004</i>
Normanville—Area 1	<i>inserted by 252/1997 r 4</i>	<i>24.12.1997</i>
	<i>varied by 215/1998 r 3(h)</i>	<i>17.12.1998</i>
	<i>substituted by 260/1999 r 3(h)</i>	<i>16.12.1999</i>
	<i>deleted by 255/2004 r 4(10)</i>	<i>16.12.2004</i>
Peterborough— Area 1	<i>inserted by 267/2001 r 3(h)</i>	<i>20.12.2001</i>
	<i>varied by 236/2002 r 3(h)</i>	<i>19.12.2002</i>
	<i>varied by 252/2003 r 4(1), (2)</i>	<i>18.12.2003</i>
	<i>deleted by 255/2004 r 4(10)</i>	<i>16.12.2004</i>
Peterborough— Area 2	<i>inserted by 267/2001 r 3(h)</i>	<i>20.12.2001</i>
	<i>varied by 236/2002 r 3(i)</i>	<i>19.12.2002</i>
	<i>varied by 252/2003 r 4(3)</i>	<i>18.12.2003</i>
	<i>deleted by 255/2004 r 4(10)</i>	<i>16.12.2004</i>
Port Augusta— Area 1	<i>inserted by 196/1999 r 3</i>	<i>30.9.1999</i>
	<i>deleted by 267/2001 r 3(h)</i>	<i>20.12.2001</i>
	<i>inserted by 175/2002 r 3</i>	<i>29.8.2002</i>
	<i>deleted by 255/2004 r 4(10)</i>	<i>16.12.2004</i>
Port Augusta—Area 1	inserted by 190/2005 r 4	1.9.2005

Liquor Licensing (Dry Areas—Short Term) Regulations 1997—29.11.2007 to 5.12.2007
 Legislative history

<i>Port Augusta— Area 2</i>	<i>inserted by 196/1999 r 3</i>	<i>30.9.1999</i>
	<i>deleted by 267/2001 r 3(h)</i>	<i>20.12.2001</i>
	<i>inserted by 175/2002 r 3</i>	<i>29.8.2002</i>
	<i>deleted by 255/2004 r 4(10)</i>	<i>16.12.2004</i>
Port Vincent— Area 1	inserted by 255/2004 r 4(10)	16.12.2004
	varied by 272/2005 r 4(10)	15.12.2005
	varied by 260/2006 r 4	7.12.2006
	varied by 272/2007 r 4	29.11.2007
Robe—Area 1	inserted by 260/1999 r 3(i)	16.12.1999
	substituted by 292/2000 r 3(h)	21.12.2000
	substituted by 267/2001 r 3(h)	20.12.2001
	varied by 236/2002 r 3(j)	19.12.2002
	varied by 270/2003 r 4(1)	18.12.2003
	varied by 255/2004 r 4(11)	16.12.2004
	varied by 272/2005 r 4(11)	15.12.2005
	varied by 262/2006 r 4(1)	7.12.2006
Robe—Area 2	inserted by 260/1999 r 3(i)	16.12.1999
	varied by 292/2000 r 3(i)	21.12.2000
	substituted by 267/2001 r 3(h)	20.12.2001
	varied by 236/2002 r 3(k)	19.12.2002
	varied by 270/2003 r 4(2)	18.12.2003
	varied by 255/2004 r 4(12)	16.12.2004
	varied by 272/2005 r 4(12)	15.12.2005
	varied by 262/2006 r 4(2)	7.12.2006
Robe—Area 3	inserted by 260/1999 r 3(i)	16.12.1999
	varied by 292/2000 r 3(j)	21.12.2000
	substituted by 267/2001 r 3(h)	20.12.2001
	varied by 236/2002 r 3(l)	19.12.2002
	varied by 270/2003 r 4(3)	18.12.2003
	varied by 255/2004 r 4(13)	16.12.2004
	varied by 272/2005 r 4(13)	15.12.2005
	varied by 262/2006 r 4(3)	7.12.2006
Robe—Area 4	inserted by 267/2001 r 3(h)	20.12.2001
	varied by 236/2002 r 3(m)	19.12.2002
	varied by 270/2003 r 4(4)	18.12.2003
	varied by 255/2004 r 4(14)	16.12.2004
	varied by 272/2005 r 4(14)	15.12.2005
	varied by 262/2006 r 4(4)	7.12.2006
Robe—Area 5	inserted by 267/2001 r 3(h)	20.12.2001
	varied by 236/2002 r 3(n)	19.12.2002
	varied by 270/2003 r 4(5)	18.12.2003

	varied by 255/2004 r 4(15)	16.12.2004
	varied by 272/2005 r 4(15)	15.12.2005
	varied by 262/2006 r 4(5)	7.12.2006
Spalding—Area 1	inserted by 236/2006 r 4	19.10.2006
	varied by 232/2007 r 4(1), (2)	20.9.2007
<i>Roxby Downs— Area 1</i>	<i>inserted by 244/2000 r 3</i>	<i>12.10.2000</i>
	<i>deleted by 255/2004 r 4(16)</i>	<i>16.12.2004</i>
Tumby Bay—Area 1	inserted by 215/1998 r 3(i)	17.12.1998
	varied by 260/1999 r 3(j)	16.12.1999
	varied by 267/2001 r 3(i)	20.12.2001
	varied by 235/2002 r 3	19.12.2002
	varied by 228/2003 r 4	20.11.2003
	varied by 255/2004 r 4(17)	16.12.2004
<i>Victor Harbor— Area 1 before substitution by 236/2004</i>	<i>inserted by 252/1997 r 4</i>	<i>24.12.1997</i>
	<i>varied by 215/1998 r 3(j)</i>	<i>17.12.1998</i>
	<i>varied by 260/1999 r 3(k), (l)</i>	<i>16.12.1999</i>
	<i>varied by 292/2000 r 3(k)</i>	<i>21.12.2000</i>
	<i>substituted by 215/2002 r 3(a)</i>	<i>14.11.2002</i>
	<i>varied by 224/2003 r 4(1)</i>	<i>6.11.2003</i>
Victor Harbor— Area 1	substituted by 236/2004 r 4(1)	11.11.2004
	varied by 241/2005 r 4(1)	17.11.2005
	varied by 247/2006 r 4(1), (2)	9.11.2006
	varied by 251/2007 r 4(1)	1.11.2007
Victor Harbor— Area 2	inserted by 260/1999 r 3(m)	16.12.1999
	varied by 292/2000 r 3(l)	21.12.2000
	varied by 215/2002 r 3(b)	14.11.2002
	varied by 224/2003 r 4(2)	6.11.2003
	varied by 236/2004 r 4(2)	11.11.2004
	varied by 241/2005 r 4(2)	17.11.2005
	substituted by 247/2006 r 4(3)	9.11.2006
	varied by 251/2007 r 4(2)	1.11.2007
Victor Harbor— Area 3	inserted by 247/2006 r 4(3)	9.11.2006
	varied by 251/2007 r 4(3)	1.11.2007
Sch 2		
<i>Adelaide—Plan 1</i>	<i>deleted by 255/2004 r 5(1)</i>	<i>16.12.2004</i>
<i>Adelaide—Plan 2</i>	<i>inserted by 252/1997 r 5</i>	<i>24.12.1997</i>
	<i>substituted by 260/1999 r 4(a) (Sch)</i>	<i>16.12.1999</i>
	<i>deleted by 255/2004 r 5(1)</i>	<i>16.12.2004</i>

Liquor Licensing (Dry Areas—Short Term) Regulations 1997—29.11.2007 to 5.12.2007
 Legislative history

Alexandrina Council—Plan 1	inserted by 252/1997 r 5	24.12.1997
Alexandrina Council—Plan 2	inserted by 252/1997 r 5	24.12.1997
Alexandrina Council—Plan 3	inserted by 252/1997 r 5	24.12.1997
Alexandrina Council—Plan 4	inserted by 252/1997 r 5	24.12.1997
Alexandrina Council—Plan 5	inserted by 252/1997 r 5	24.12.1997
Alexandrina Council—Plan 6	inserted by 255/2004 r 5(2) (Sch 1)	16.12.2004
<i>Beachport—Plan 1</i>	<i>inserted by 252/1997 r 5</i>	<i>24.12.1997</i>
	<i>deleted by 215/1998 r 4(a)</i>	<i>17.12.1998</i>
Beachport—Plan 1	inserted by 257/2007 r 5 (Sch 1)	15.11.2007
Glenelg—Plan 1	inserted by 260/1999 r 4(b) (Sch)	16.12.1999
	substituted by 272/2005 r 5 (Sch 1)	15.12.2005
	substituted by 266/2006 r 5 (Sch 1)	7.12.2006
Murray Bridge—Plan 1	inserted by 252/2006 r 5 (Sch 1)	16.11.2006
<i>Normanville—Plan 1</i>	<i>inserted by 252/1997 r 5</i>	<i>24.12.1997</i>
	<i>substituted by 260/1999 r 4(b) (Sch)</i>	<i>16.12.1999</i>
	<i>deleted by 255/2004 r 5(3)</i>	<i>16.12.2004</i>
Port Augusta—Plan 1	inserted by 196/1999 r 4	30.9.1999
	deleted by 267/2001 r 4	20.12.2001
	inserted by 175/2002 r 4	29.8.2002
	deleted by 255/2004 r 5(3)	16.12.2004
	inserted by 190/2005 r 5 (Sch 1)	1.9.2005
<i>Port Augusta—Plan 2</i>	<i>inserted by 196/1999 r 4</i>	<i>30.9.1999</i>
	<i>deleted by 267/2001 r 4</i>	<i>20.12.2001</i>
	<i>inserted by 175/2002 r 4</i>	<i>29.8.2002</i>
	<i>deleted by 255/2004 r 5(3)</i>	<i>16.12.2004</i>
Port Vincent—Plan 1	inserted by 255/2004 r 5(3) (Sch 1)	16.12.2004
Robe—Plan 1	inserted by 260/1999 r 4(c) (Sch)	16.12.1999
	substituted by 292/2000 r 4	21.12.2000
	substituted by 267/2001 r 4	20.12.2001
Robe—Plan 2	inserted by 260/1999 r 4(c) (Sch)	16.12.1999
	substituted by 267/2001 r 4	20.12.2001
Spalding—Plan 1	inserted by 232/2007 r 5 (Sch 1)	20.9.2007
Tumby Bay—Plan 1	inserted by 215/1998 r 4(b)	17.12.1998
Victor Harbor—Plan 1	inserted by 252/1997 r 5	24.12.1997
	substituted by 215/2002 r 4	14.11.2002

	substituted by 236/2004 r 5 (Sch 1)	11.11.2004
	substituted by 247/2006 r 5 (Sch 1)	9.11.2006
Victor Harbor— Plan 2	inserted by 247/2006 r 5 (Sch 1)	9.11.2006

Historical versions

Reprint No 1—24.12.1997
 Reprint No 2—17.12.1998
 Reprint No 3—30.9.1999
 Reprint No 4—16.12.1999
 Reprint No 5—12.10.2000
 Reprint No 6—21.12.2000
 Reprint No 7—20.12.2001
 Reprint No 8—29.8.2002
 Reprint No 9—14.11.2002
 Reprint No 10—19.12.2002
 Reprint No 11—6.11.2003
 Reprint No 12—20.11.2003
 Reprint No 13—18.12.2003
 11.11.2004
 16.12.2004
 1.9.2005
 17.11.2005
 15.12.2005
 19.10.2006
 9.11.2006 (electronic only)
 16.11.2006
 7.12.2006 (electronic only)
 14.12.2006
 20.9.2007
 1.11.2007
 15.11.2007